

A

X See by Mr Peets, no elements noted on card.

RECORD CARD FOR ECCLESIASTICAL MONUMENTS.

(N.B.—Detail of special interest is to be entered here, but described fully on separate card.)



Print 1
10.11.11

1. Dedication and Situation:

S. Nicholas

2. Historical Development: (with dates and small sketch plan).

The building appears to have been an aisleless church dating from about 1200 to 1220 (with Nave, Chancel & West Tower of S. porch) to which Aisles were added c. 1230. Windows have been inserted at different periods: in the 14th century the East wall & part of the N. wall of the chancel were rebuilt & the top of the tower reconstructed. In the 15th century the building without being altered to any great extent in plan appears to have undergone a certain amount of reconstruction notably in the E. walls of the Nave & Aisles: the chancel arch was thinned into 3 joints cut back, and the East walls of both aisles were

thinned in the upper half of each wall: the close proximity of the S. low side window - and

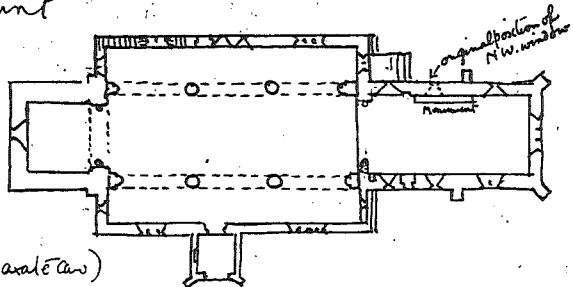

3. Special features (if any):

4. Architectural description, from East to West: (with dates and measurements).

Chancel (26 1/2 by 13 ft): East window of three trefoiled ogee headed lights and quatrefoiled tracery in two-centred head with moulded label: 3 played joints & arch inside, and chamfered rear arch: c. 1330. East wall a 14th c. rebuilding with part of N. wall.

North two lancet windows one near East end, the other near West end: both early 13th cent. Below the latter a blocked window (square) and East of it a recess which was probably a later window: the lancets have 3 played almost circular heads inside.

South wall three windows: East of two trefoiled ogee headed lights under a square head with moulded joints and label all of a very dark brown limestone: dates from c. 1360. Second window a 13th c. lancet like the others: this window a 15th cent. cinquefoiled single light with four-centred arch in square head: sunk spandrels; has a modern transom, below which the stone is modern outside except one stone in E. joint: above the transom window is old: inside, the existing window edge is placed above the old one which is set low in wall. Between the 2nd & 3rd windows a 13th c. doorway with pointed arch & semicircular rear arch.

Both N & S walls have 13th cent. string courses outside: one below the sill-level of lancets; a 2nd for the low sides. The other at the springing level of the lancet heads above which it is carried to form labels.

Chancel arch: of early 13th c. date, rebuilt and altered at a later period probably in the 15th century: the arch is two-centred and retains two of the moulded orders & label, on the West side: it has been much thinned on the East side & sets back from the original E. face of the joints: the joints have chamfered edges with moulded abaci and in the middle an attached circular shaft: both shafts have modern bases: the North capital is carved with an enriched scalloped ornament and the S. capital has an early form of foliage: the S. joint has been nearly half cut away on its East side and a moulded corbel put in to carry the overhanging arch.

Nave (41 ft by 13 ft) has N & S arcades of three bays: both are probably of early 13th century origin but the caps all differ slightly in detail some probably the result of later re-cutting: one arch the S.E. bears signs of having been rebuilt (continued on separate card)

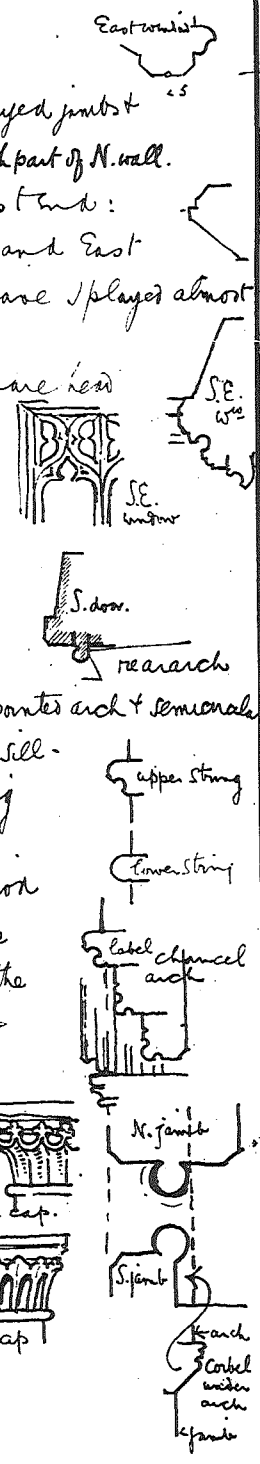

County. Bucks.

Parish. Jekford

Sub-Commission. Ecclesiastical

No. of Monument. 1/a

P.T.O.

5. Description of fittings: (in alphabetical order, with position and dates).

Fittings.
(Reminder list.)

- (1) Altars.
 - * (2) Bells.
 - * (3) Brackets for images.
 - (4) Brasses and indents.
 - (5) Chairs.
 - (6) Chests.
 - * (7) Communion tables and rails.
 - (8) Cupboards.
 - (9) Doors (oak, &c.).
 - (10) Easter sepulchre.
 - * (11) Font and font-cover.
 - (12) Galleries.
 - * (13) Glass.
 - * (14) Images.
 - (15) Lectern.
 - (16) Libraries.
 - (17) Lockers.
 - * (18) Monuments and floor slabs.
 - (19) Niches.
 - * (20) Paintings (mural) and pictures.
 - * (21) Panelling.
 - * (22) Piscinae.
 - * (23) Plate.
 - (24) Poor-box
 - * (25) Pulpit.
 - (26) Recesses.
 - * (27) Registers.
 - (28) Reredos.
 - (29) Royal Arms.
 - (30) Screens.
 - * (31) Seating.
 - (32) Sedilia.
 - (33) Stalls.
 - * (34) Stoups (holy water).
 - (35) Tiles.
 - (36) Miscellaneous (including clocks, hour-glass stands, rain-water heads, sun dials, &c.).
- N.B. — Heraldry to be noted where it occurs.

Altar slab a stone found in the floor at the East end of the N. Arcade has been placed on the 17th c. communion table in the chancel as the former altar slab: it has been redressed.

Bells three B^l has a number of meaningless letters & signs: date & maker uncertain: 2. by Chandler 1716 3rd Ellis Knight 1723: Small sanctus of 1847.

Brackets for images Two plain bracket flanking E. window of chancel: chamfered; semi-octagonal

Communion table: 17th c. with turned legs: in chancel

Door Outside door: oak plain one of 17th c. date.

Font see separate card

Gallery modern one at W. end said to be an old line: the front made up of some 17th c. panelling.

Glass see separate card

Monuments see separate card

Niches At E. end of N. arcade (Sd. E. window) a trefoiled niche with chamfered steps: it has chamfered steps one is lower than the other row, but before the restoration the wall is said to have sunk to the south but the steps were level with each other showing that the settlement took place before the niche was put in, probably in the 15th century.

Paintings Traces of red paint on the chancel arch, & on the E. window of N. arcade no certain pattern remaining.

Piscinae 1. In chancel: circular basin on pointed capital all old chamfered jamb to help at base probably 13th century head is modern

2. In E. aboad of N. arcade (N. side) is a 15th c. inserted piscina with a multi-lobed basin: pointed arch cut in the respond.

3. In the N. arcade a round headed piscina: half the circular basin broken away & drawn across on face. 13th c.

Plate very large cup of 1661. & standing plate same date, silver of 1722

Pulpit see separate card

Registers P^l book 1562 (copy of 1597-8) to 1727

Seating a number of plain panellied seats in Nave probably late 16th c.

Stoup E. of S. doorway in S. aisle a trefoiled head of recess: half of it is old said to have been found in its present position with part of the plastered round back of recess: all a modern copy of the chancel piscina: set very low in the wall.

Miscellaneous ^{Three} stones in chancel were found in the wall of probably belonged to the original bell chamber window: one has been used twice & is originally part of a trefoiled head: another was a filigree cap of a shaft.

Small holes cut in the E. respond of N. arcade for former wood rails of sacros (see sketch)

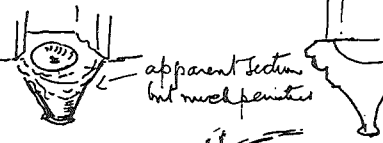

apparent section but much penetrates

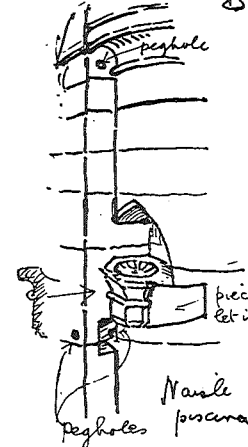

N. arcade piscina



6. Churchyard:

Condition: Good: The building has been well & carefully restored

8. Visited by: (with dates). W. Bloe & J. Murray Kendall May 23rd 1911

W. B. (2nd) May 26th

9. Bibliography:

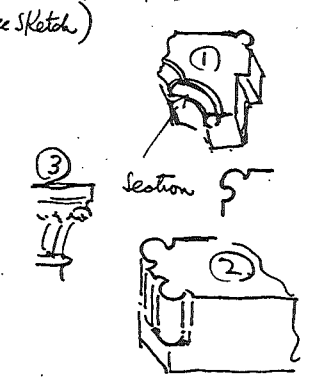

10. No. of Ordnance Sheet (6 in.):

11. Signature of Investigator: W. Bloe

Parish Church

History (continued)



of the small locker W. of it, ~~was~~ placed in the space formerly occupied by the remainder of the former sk. so that the alteration took place probably in the 15th century

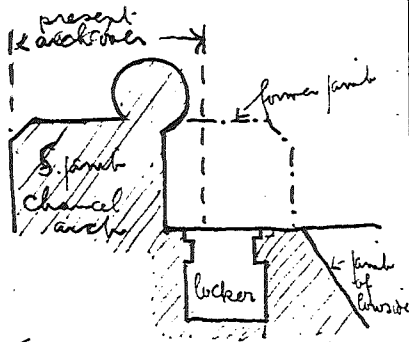

The south porch was added probably in the 15th century & reconstructed in the 16th century or early 17th century. A restoration took place in 1875 but little was done as the church in 1900 was in very bad condition and the building was put into thorough repair in 1906 under the present Rector who states that the S. wall of the chancel was rebuilt from its foundations, the NW. window of the chancel was removed from its original position (further East) to make room for the large Monument which was then in the North Aisle, that the windows in the N. Aisle formerly hidden by the monument were opened out, that the head of the lancet at the W. end of the S. Aisle was found buried in the S. wall & adopted to its present position & other stonework was restored: the present W. gallery was put in, evidence of a former one having been found, the seats (formerly box pews) were modernized & the pulpit (formerly a "three decker") was re-constructed. He also states that the arcades were found to have no bond with the earlier East & West walls of the Nave.

Architectural Description (continued)

The responds are semicircular the pillars circular: the bases are simple mostly with square plinths but the base of the 2nd S. pillar is more elaborate: all circular. The capitals are wells of fairly simple form the 1st S. cap & the 2nd N. cap ~~are~~ have been recut. The 3rd S. cap is a much more elaborate one than the rest having a moulded abacus, and a bell surmounted with a very early form of foliage.

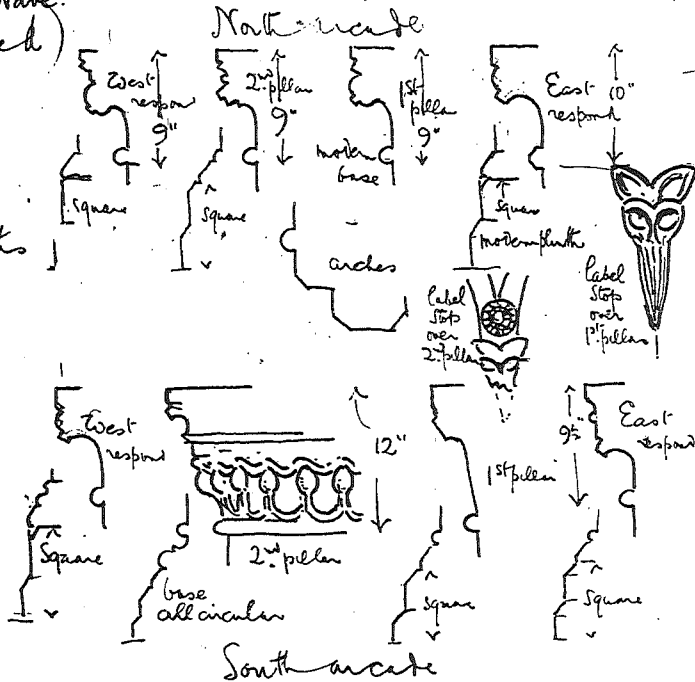

a moulded abacus, and a bell surmounted with a very early form of foliage. The arches are of two chamfered orders (with small voussours) and have plain round labels mitring together over the S. pillars but having stops over the N. pillars, that is the 1st pillar being a very long beak head and the other a beak head (hook) and a ring over it. Vertical joints over each pillar bridge that the arches are each ~~separately~~ ^{separately}. No clear storey but a modern tower window on the S. side at the W. end.

N. Aisle (6 1/2 ft wide) East window a window of two lancet lights, the head in one long stone: old angle stones made to joints and modern wood lintel: the window is probably a late one - 16th c. North wall 1st window of three cinquefoiled lights under a square head ~~of stone~~ with a moulded label which is placed at unequal distances from the lights at each end.

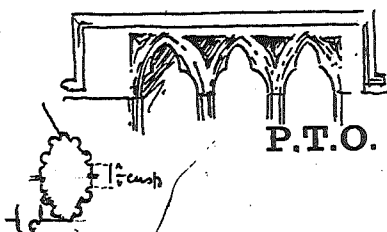

County. Bucks

Parish. St John

Sub-Commission. Ecclesiastical

No. of Monument. 14

The ledge is made up of 13th c. string course and has on its upper face some square scratching or incised lines of no apparent significance: the lintel inside is of modern oak. The jambs and mullions are moulded: the spandrels in the head between the lights appear to have been subsequently enlarged but the window otherwise appears to be an early example of a square headed window of this sort & dates probably from the middle of the 14th century c 1360. The second window is a tiny lancet of early 13th c. date with rebated & splayed outer jambs and widely splayed inner jambs; the rear arch inside is a trefoiled one with sunk spandrels containing a circular flower; it is obviously a bad fit on the splayed jambs and is probably of early 16th c. date. The third window is close to the second but much higher in the wall; this is of similar section outside but has a round head it is probably contemporary with the other & both belonged possibly to the original N.A.; their present positions could be more easily explained if the ch. try chapels which probably existed here could be re-constructed. The N. doorway, close to the 3rd window, has plain chamfered jambs and ~~is~~ a semi-circular arch probably of early 13th century date. The fourth window is of two lancet lights: the jambs are like the others in section and are probably of early 13th c. date, but the two arches are irregularly cut all out of one stone which has a horizontal rebate inside suggesting that the heads & the mullion are all of later date probably 16th century. The sill is made up of 13th c. string course and the inner lintel is of oak. The west window is of two lights & appears to be another 16th c. adoption of 13th c. work: the heads of the lights are almost round-headed and are in one piece of stone: inside, it has a round interior to the other window.

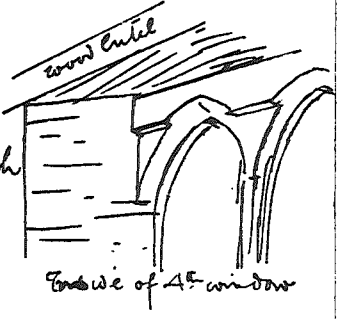
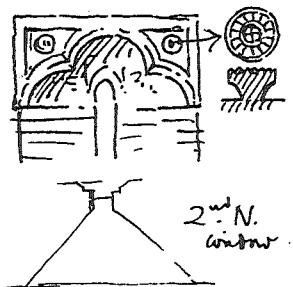

South Aisle. Eastern half is of four plain square-headed lights with a moulded label outside & wood lintel inside. The 2nd in W. half is a modern copy of the 1st N. window in N. Aisle. The South doorway is contemporary with the Chancel arch etc. & belonged to the original aisleless church; the wall in which it was set was probably the outer or South wall of the original S. porch to the face of which the present South aisle was built, the side walls of the porch being removed. The jambs are of two orders the inner with an edge roll, the outer chamfered, with a detached shaft in the angle between the two orders both shafts have moulded bases, and intermediate bands: the E. cap is a square moulded one & is probably a later one than the W. stone which has a curved foliage, which perished & a moulded abacus. The inner order of the arch is a four-centred, continuous with the roll from the jambs and is of 15th cent. date when the doorway appears to have been re-modelled: the outer order is moulded and forms a high pointed arch without a label: it has also been rebuilt probably in the 15th c. Over the doorway are two pieces of weathering belonging to the original porch. A 13th c. string course below the windows inside.

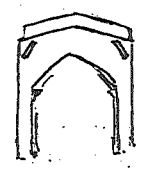
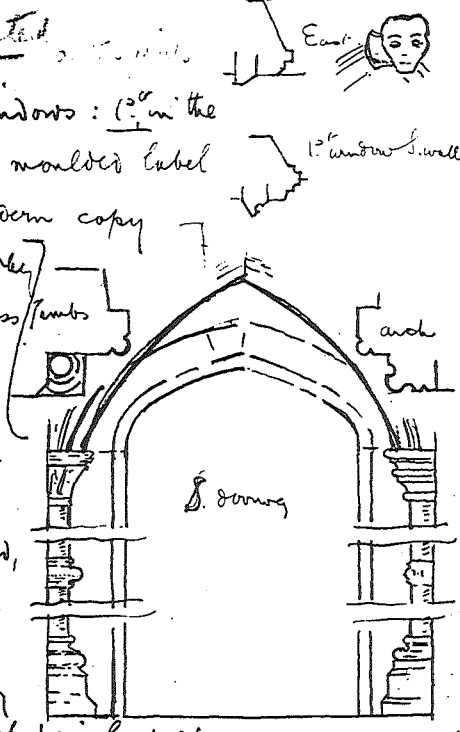

Description (continued)

South Aisle (continued)

West wall. Small lancet window with 13th c. head + modern jambs to ill: the head was found buried in the S. wall + was put into its present position: over it a small quatrefoil light probably 13th c.

West Tower (10 1/2 ft sq.) of two stages with a saddle back tiled roof:

The archway from the Nave has chamfered square jambs with very small central shafts (detached): the shafts have moulded bases and ~~the S. shaft has a later length of~~ octagonal shaft: The N. cap ogee shaped carved with a four lobed ornament, + mould abacus: the S. cap has a ~~rather~~ more elaborate form of insipient leaf.

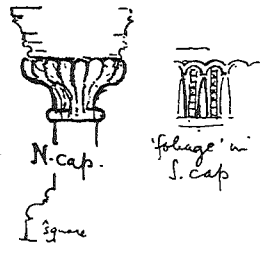

The arch is two-centred of two chamfered orders + has a plain round label on the East side

The W. window is a 13th c. lancet with a small round label on side: the joints thereabove are played. The upper story of the lower stage has a round headed ^{single light} window on the N. side, + 2 similar blocked lights in the W. + S. walls; in the E. wall was a doorway into the roof space, now reduced to a modern loop. The bell chamber - a second stage

has the original 13th c. windows on the W. side, of two trefoiled lights with tympana over within high lancet pointed outer orders with labels. On the N, E. + S. walls are 14th c. windows of two trefoiled ogee-headed lights with a quatrefoil over, in a two-centred head with a moulded label having masks tops. The E. window of one

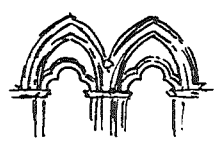

chamfered order, the two side windows of two. In the E. wall is a vertical straight joint with an edge roll showing the position of the 13th c. (former) window in the S. half of the wall: in the S. wall is a shorter length of similar roll mould showing that the side walls had similar double ~~double~~ windows and that the side walls were originally as high as the E + W. walls.

The E + W walls are gabled, the former thrust above the window, and both have the remains of original (14th c.) crosses. In the face of the S. wall. is set a foreign stone which appears to be a carved head of a canopy: it has no connection with any other detail near it.

The South porch has blocked side windows of which only ^{on the E. wall is the weathering of the original higher Nave roof} P.T.O.



County. *Bedford*

Parish. *St. Andrew*

Sub-Commission. *Bedford*

St. Andrew

No. of Monument. *1/c*

the inner played joints remain, no evidence of them being visible outside
 On either side of the E. window is a small square hole = 4/6 deep of no
 apparent use unless they were putlog holes. The outer archway of the
 porch has an old two-centred high segmental arch of which an edge roll
 mould: it is not improbable that this was the original inner arch of
 the S. doorway & was m. ed out to its present place when the inner arch
 of the S. doorway was remodelled in the 15th: it has one modern stone
 but the joints are all modern: Inside is a wood frame probably of the
 17th. and an old door. Wall over doorway has low pitched gable coping of 15th. and over that
 a higher pitched modern gable in which is set a small cross with a cross cut in it

Walls
Pathways + materials

Generally of rubble with stone dressings
Chancel E + N wall up to the 1st lancet of mixed rubble probably 14th.
 Original buttresses at angles probably 14th: of ashlar: plinths modern
 The other walls of chancel of uncoursed small rubble with a number of
 large stones. The SE window of chancel is of a dark brown
 sanguinous stone (Hobbiton stone) and it is said that when the wall was
 examined before it was rebuilt it bore certain evidences that this window was
 merely adopted to its present position after being brought from elsewhere
 and was put in to light the large 17th. monument which stood right
 opposite it in the chancel: the foundations for this monument were discovered
 showing its exact original position - further east than its present place.
 Immediate buttresses in each side wall may be of 13th. date: the N one is much modernized.

The aisle walls of small coursed rubble on N + S sides - except to W of
 S. porch which has larger stones: The E wall of the Naisle
 sets back 7ft above the ground probably the result of a thinning
 the E wall of the aisle above the set back being but 1ft 8in thick.
 The E wall of Saisle has a similar set back the wall being 1ft 10" thick
 Both aisle walls have a good deal of old cement on them: & have
 chamfered plinth
 Lower walls small rubble with much cement.

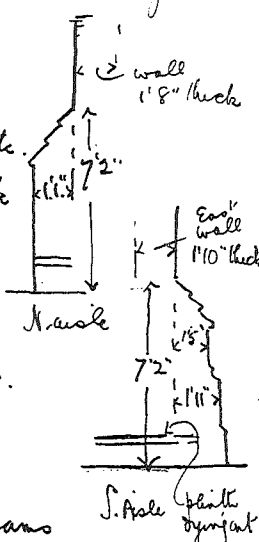

Nave East end gables of rubble: on the apex remain of an old cross.

Roofs: Chancel high pitched: old rough teabears & trussed ~~rafter~~ collar beams
 + rafters formerly lathed: date uncertain ^{possibly 15th} plaster ceiling between
 rafters: wallplate said to 15th & short of the present chancel aisle wall showing that latter was thinned
 Nave: has four old beams chamfered: date uncertain: ~~marked~~ under the
 Western most tie on the N. side is a moulded corbel ^{on a stone corbel} post ^{probably} put in the
 17th. to strengthen the end of the tie. Remainder modern
 Aisles modern lean to roof covered with lead
 Porch has two teabears of late 15th. or early 16th. date: the S. tie is moulded & has a
 Tudor rose boss in centre: the N. tie is modern with an old boss re set: it is carved as a
 face (? a lion): moulded cornice: the queen post trusses above these ties have
 been cut away & the higher pitched roof is of modern date.



Floors modern stone flags + squares. From the height of the S. door, ~~Masses~~ Holywell Street E of aisle,
 Piscina in chancel, plinth of tower to. the original floor must have been much lower than
 at present but the bases of the arcades & the of aisle piscina show that the floor was raised
 at a fairly early date to its present level.

Parish Church

○ Fittings Continued.



- Font: circular ~~bowl~~ bowl, plain, circular stem, plain moulded base, apparently 13th cent much scraped and restored.
- Glass in E. window of chancel; in quatrefoils of tracery four-leaf foliage with shields, original, ^{c1350,} but shields except in one case modern, old shields apparently barry or and azure over all a bend gules; in heads of main lights some fragments. In lancet window of N. aisle small squares set diamond wise with quatrefoils and cross hatched ground in brown; 14th cent.

Monuments: -

In chancel on N. large architectural monument with high plinth with pedistalled corinthian order superimposed upon ionic order both with complete entablatures, lower mitred back upper enriched and overhanging; between lower columns is panel with ^{kneeling figures} ~~of~~ four rows and five daughters ~~above are effigies of father and mother and is inscribed~~ panel with strap work ^{with four grotesque figures.} and grotesque frame, ~~the~~ panel inscribed to Thomas Tipping Esquier, 1598, and his wife Margaret; above is a shield with a bend engrailed three pheons thereon quartering two cheverous gobony. The initials T. T. M. appear on the ionic frieze. Whole monument of crude design and workmanship. In S. aisle, mural, to Thomas Phillips, 1704 and Mary, his wife, 1681; arms: azure a leopard rampant argent a chief ermine impaling a fesse gules between three eagles displayed sable. In chancel at S. W. on floor, slab to Edmund Lawrence 1645; at W. end nave on floor, slab to "Mrs Ann Coles wife of Thomas Coles of this parish" 1695

P.T.O.

County.

Rutts

Parish.

Pekford

Sub-Commission.

Ecclesiastical

No. of Monument.

1(a)

Pulpit. Made up of 17th cent. material
canopy 17th cent, hexagonal with guilloché
enrichment.